

Notes

- Important: Carefully consider the maximum system pressure. The pressure rating of the manifold is dependent on the manifold material, with the port type/size a secondary consideration. Manifolds constructed of aluminum are not rated for pressures higher than 3000 psi (210 bar), regardless of the port type/size specified.
- For detailed information regarding the cartridges contained in this assembly, click on the models codes shown in the Included Components tab.
- This drawing is for reference only. It is generated by an automated process and does not fall under Sun's document control process.

Port Headings		
Product	Port	Size
YSDALANCK	Ports 1 & 2	SAE 10
YSDALANCK	Port 3	SAE 6

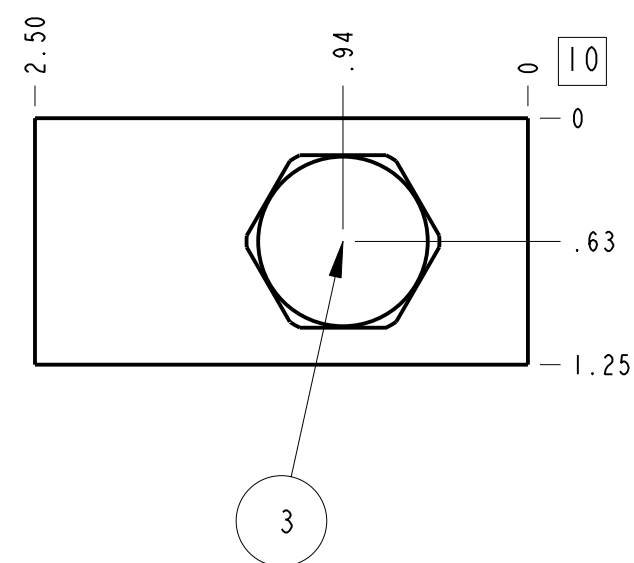

Technical Data	U.S. Units	Metric Units
Body Type	Line mount	
Weight	1.372 lb.	0.622 kg.
Capacity	15 gpm	60 L/min.
Mounting Hole Diameter	.28 in.	7.1 mm
Mounting Hole Depth	Through	
Mounting Hole Quantity	2	

3	CXDA-XCN			CHECK VALVE	1
2	RSDC-LAN			SEQUENCE VALVE	1
1	150-310-006		6061-T6 ALUMINUM	BODY	1
ITEM	PART NO.	SETTING	MATERIAL	PART NAME	QTY

MODEL		YSDALANCK		ALL DIMENSIONS IN INCH VIEWS ARE THIRD ANGLE		FIRST ANGLE		THIRD ANGLE	
DESCRIPTION		Line mount		DATE	SCALE	DWG SIZE	SHEET		
				Nov-03-23	1.027	C	1		