

Technical Data	U.S. Units	Metric Units
Body Features	On B with free flow check	
Body Type	Sandwich	
Interface	ISO 03	
Stack Height	1.76 in.	44,7 mm
Weight	1.582 lb.	0,718 kg.
Capacity	10 gpm	40 L/min.
Maximum Operating Pressure - 6061-T651 Aluminum	3000 psi	210 bar
Maximum Operating Pressure - 65-45-12 Ductile Iron	5000 psi	350 bar
Seal Plate Included (see notes)	Yes	

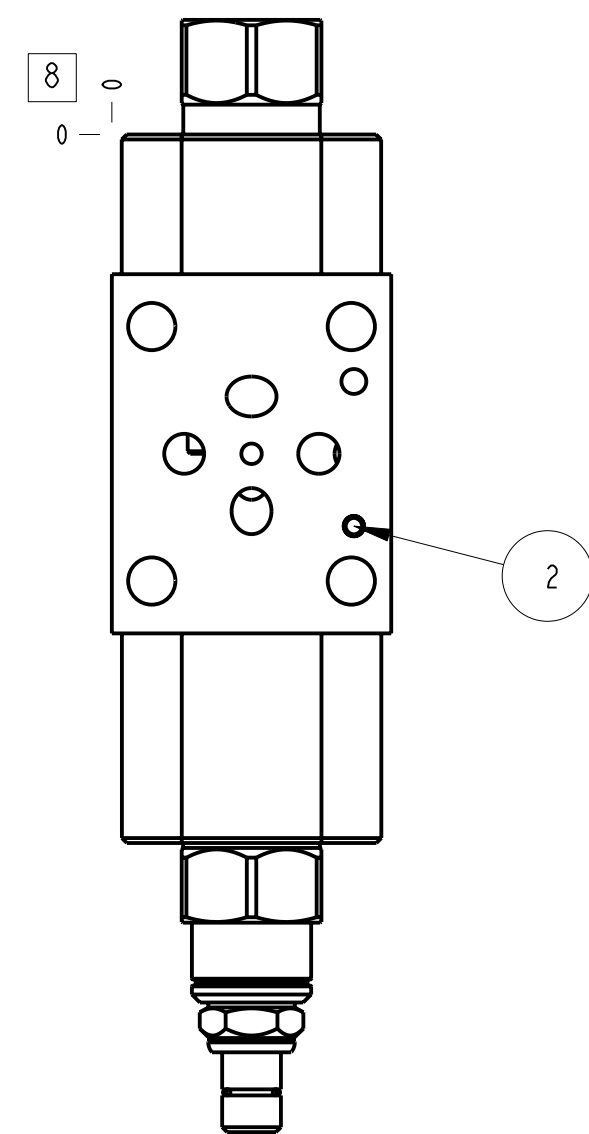
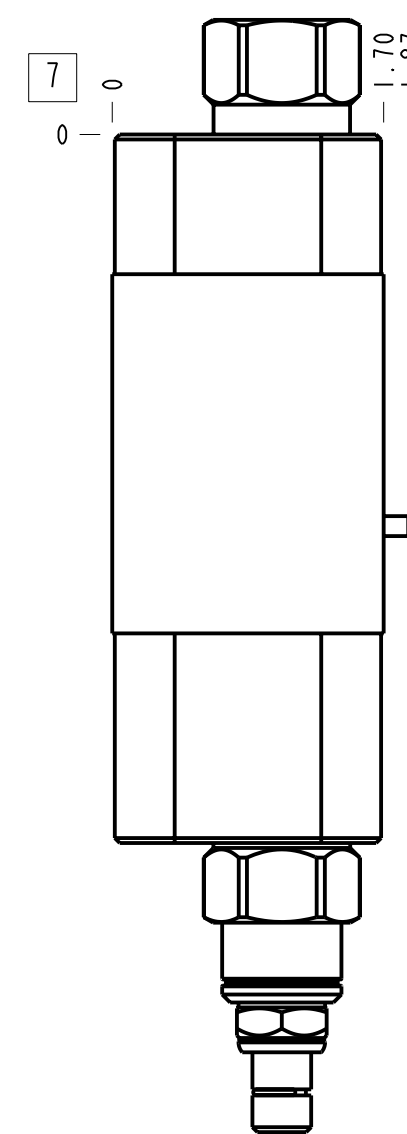

Notes

- Important: Carefully consider the maximum system pressure. The pressure rating of the manifold is dependent on the manifold material, with the port type/size a secondary consideration. Manifolds constructed of aluminum are not rated for pressures higher than 3000 psi (210 bar), regardless of the port type/size specified.
- Stack height value in technical data table includes seal retainer plate.
- For detailed information regarding the cartridges contained in this assembly, click on the models codes shown in the Included Components tab.
- This drawing is for reference only. It is generated by an automated process and does not fall under Sun's document control process.
- Items without balloons are shipped loose.

7	700-002				1
6	500-001-012				4
5	PBDBLAN			PRESSURE REDUCING VALVE	1
4	850-004-250			KOENIG EXPANDER PLUGS	2
3	CXDA-XCN			CHECK VALVE	1
2	811-001-006		LOW CARBON STEEL	PIN	1
1	150-283		6061-T6 ALUMINUM	BODY	1
I T E M	PART NO.	SETTING	MATERIAL	PART NAME	Q T Y

MODEL		YPCBLANAA		ALL DIMENSIONS IN INCH VIEWS ARE THIRD ANGLE		FIRST ANGLE		THIRD ANGLE	
DESCRIPTION		Sandwich ISO 03 On B with free flow check		DATE	SCALE	DWG SIZE	SHEET		
				Aug-14-24	0.831	C	1		