

Technical Data	U.S. Units	Metric Units
Body Features	B to A	
Body Type	Sandwich	
Interface	ISO 05	
Stack Height	1.94 in.	49 mm
Weight	2.664 lb.	1,208 kg.
Capacity	20 gpm	80 L/min.
Seal Plate Included (see notes)	No	

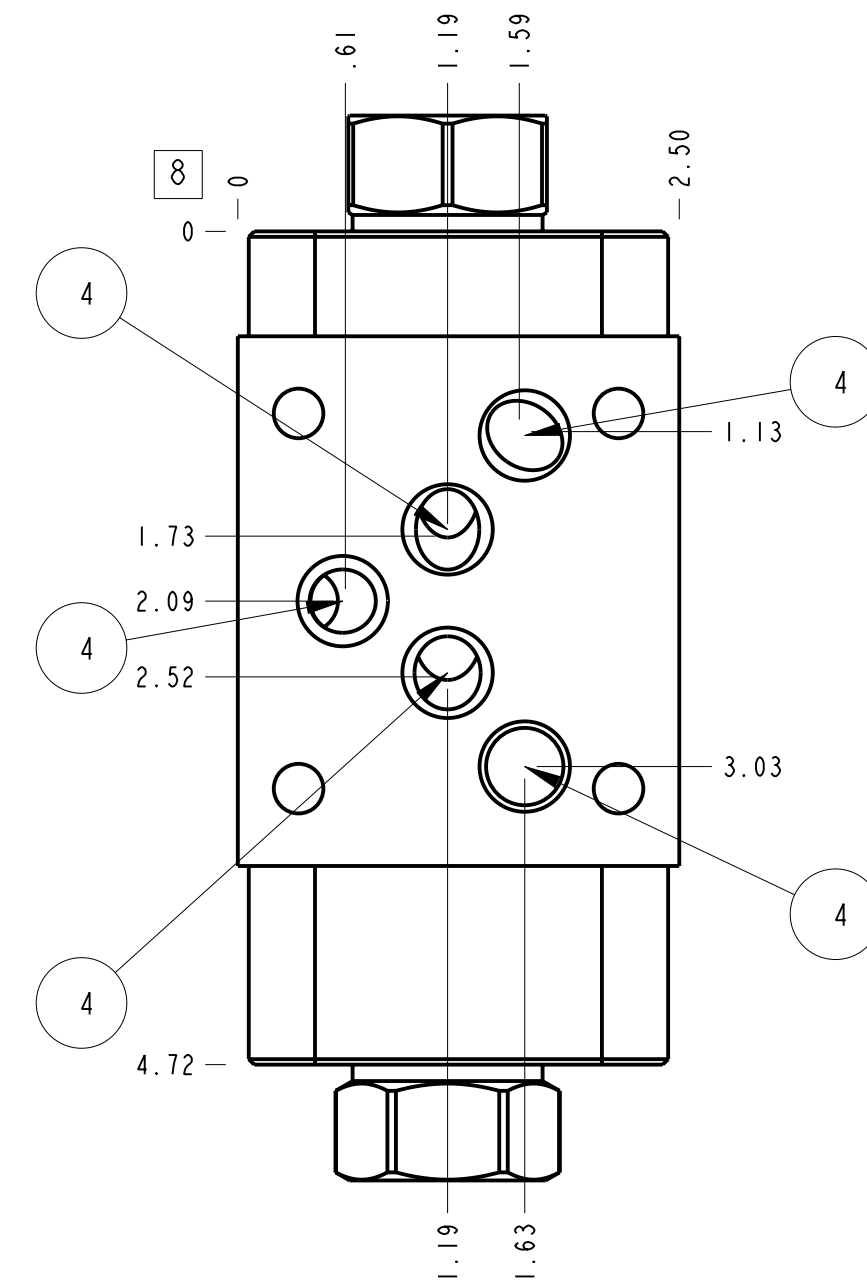
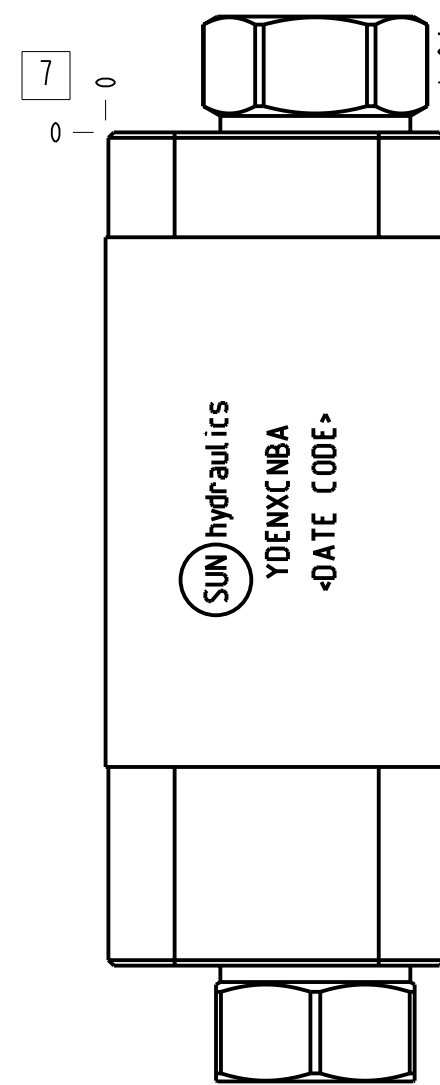

Notes

- Important: Carefully consider the maximum system pressure. The pressure rating of the manifold is dependent on the manifold material, with the port type/size a secondary consideration. Manifolds constructed of aluminum are not rated for pressures higher than 3000 psi (210 bar), regardless of the port type/size specified.
- For detailed information regarding the cartridges contained in this assembly, click on the models codes shown in the Included Components tab.

ITEM	PART NO.	SETTING	MATERIAL	PART NAME	QTY
5	CXEE-XCN			CHECK VALVE	1
4	500-001-014		N-0674-70	O-RING	5
3	340-001			PLUG-.062-27 NPTF	2
2	COFA-XEN			CHECK VALVE	1
1	150-015		6061-T6 ALUMINUM	BODY	1

MODEL		YDENXCNBA		ALL DIMENSIONS IN INCH VIEWS ARE THIRD ANGLE		FIRST ANGLE		THIRD ANGLE	
DESCRIPTION		Sandwich ISO 05 B to A		DATE	SCALE	DWG SIZE	SHEET		
				Mar-26-20	0.920	C	1		