

Technical Data		U.S. Units	Metric Units
Body Type		Line mount	
Weight		18.578 lb.	8,427 kg.
Capacity		20 gpm	80 L/min.
Maximum Operating Pressure - 6061-T651 Aluminum		3000 psi	210 bar
Maximum Operating Pressure - 65-45-12 Ductile Iron		5000 psi	350 bar
Mounting Hole Depth		Through	
Mounting Hole Quantity		2	

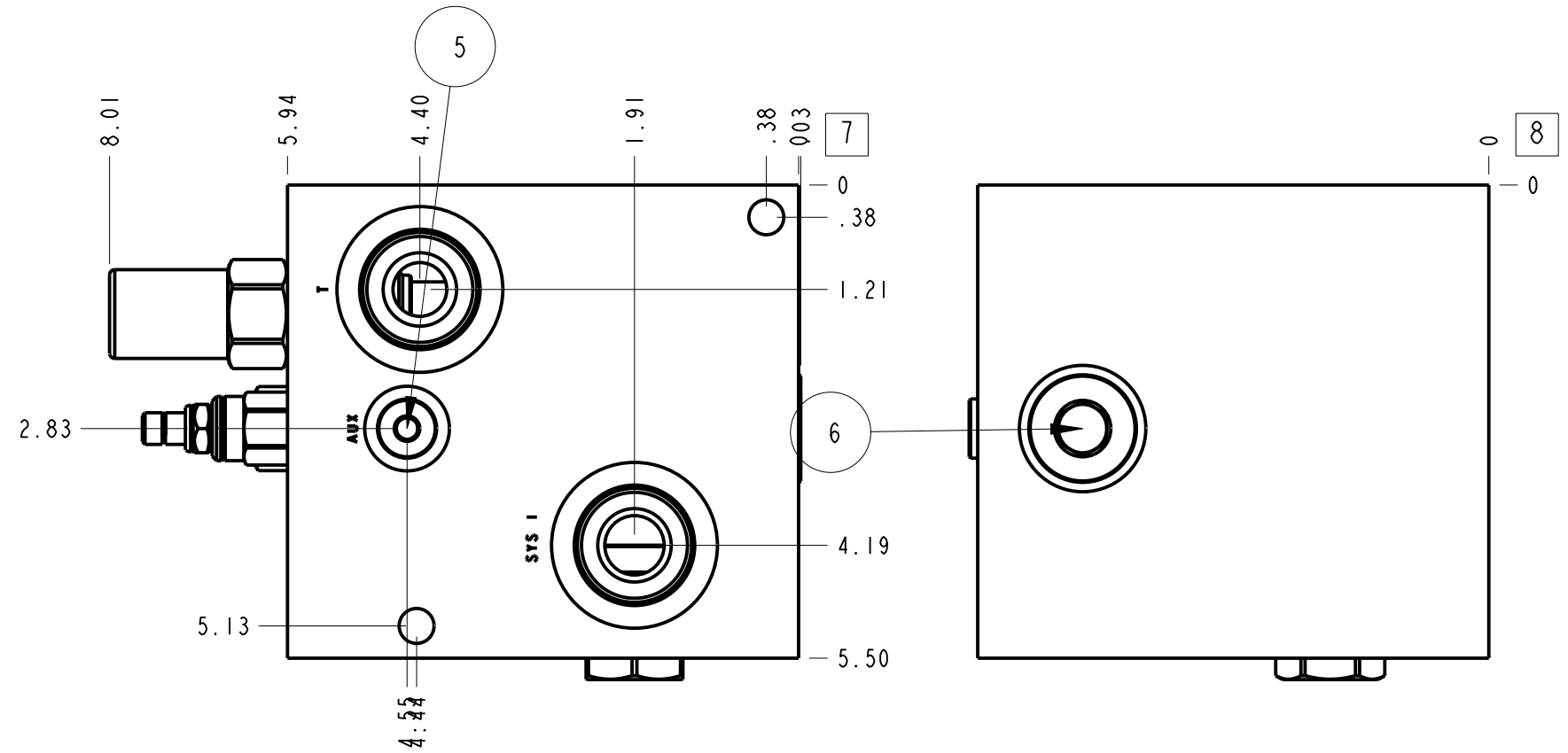

**Notes**

- Important: Carefully consider the maximum system pressure. The pressure rating of the manifold is dependent on the manifold material, with the port type/size a secondary consideration. Manifolds constructed of aluminum are not rated for pressures higher than 3000 psi (210 bar), regardless of the port type/size specified.
- For detailed information regarding the cartridges contained in this assembly, click on the models codes shown in the Included Components tab.
- This drawing is for reference only. It is generated by an automated process and does not fall under Sun's document control process.

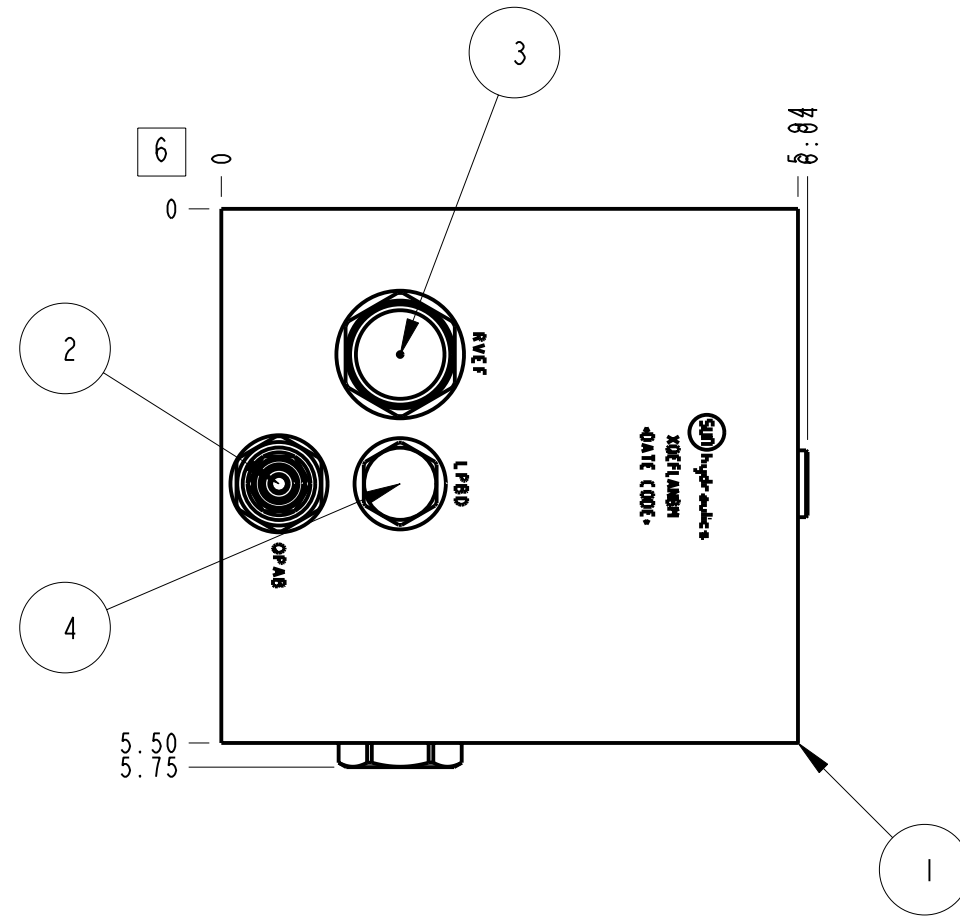
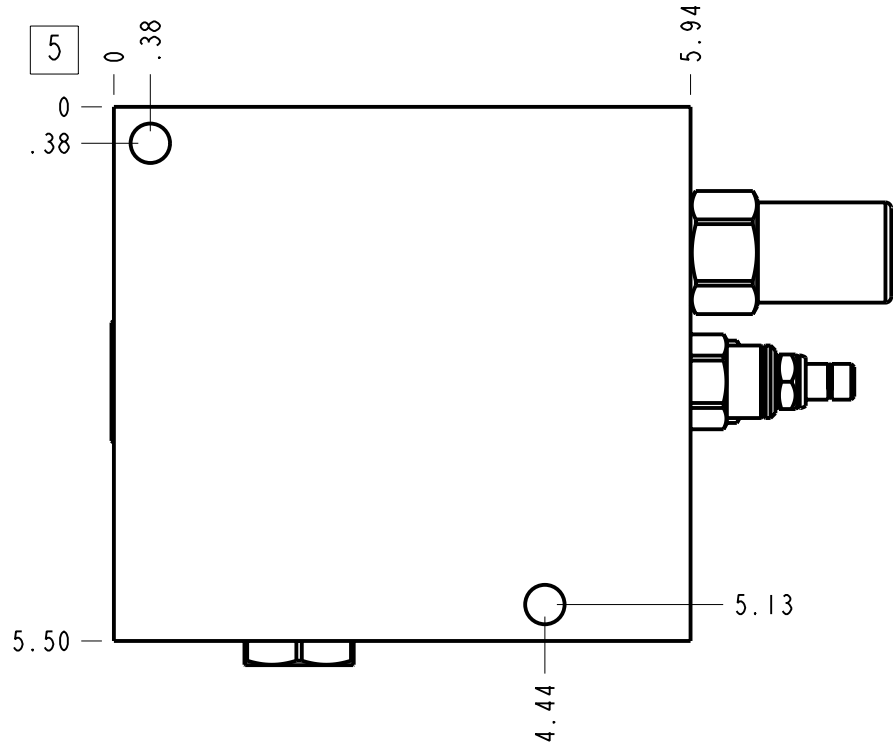
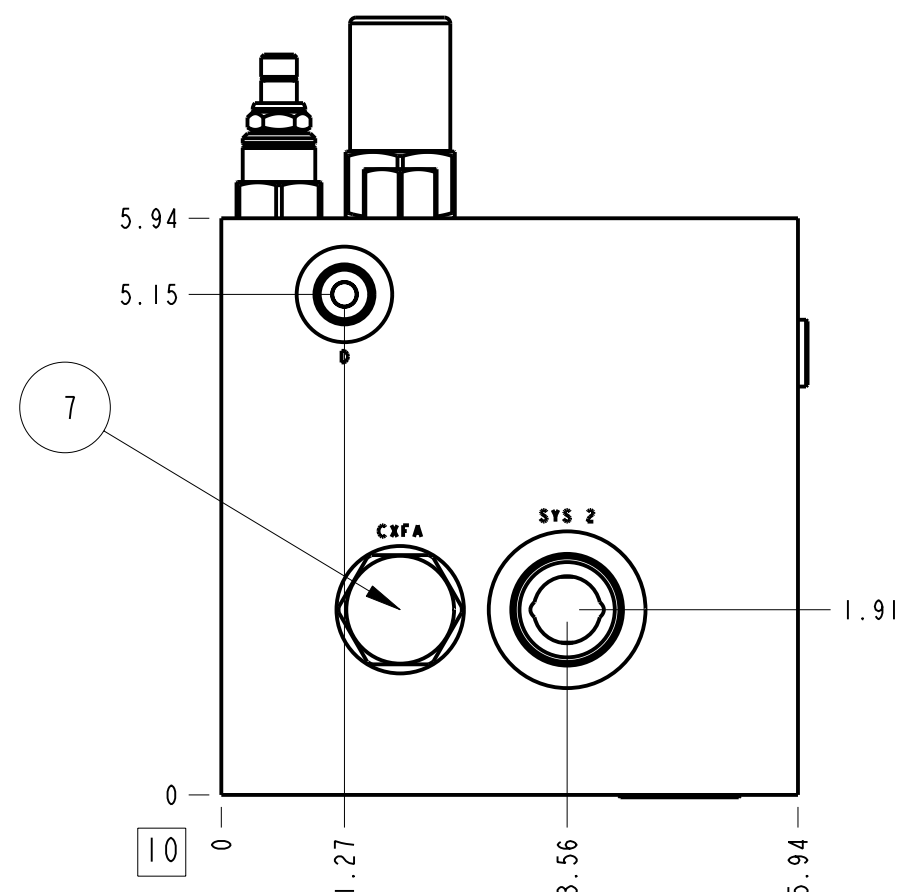

Port Headings		
Product	Port	Size
XQEFLANBM	Ports P, T, & SYS 1	SAE 16
XQEFLANBM	Port SYS 2	SAE 12
XQEFLANBM	Port G	SAE 4
XQEFLANBM	Ports D & AUX	SAE 6
XQEFLANBM	Mtg Holes	.41 DIA (10,4 mm) THRU

7	CXFA-XCN			CHECK VALVE	1
6	A330-006-012			SAE-12 PLUG	1
5	A330-006-006			SAE-6 PLUG	1
4	LPBD-XFN			MODULATING ELEMENT VALVE	1
3	RVEF-XAN			RELIEF VALVE	1
2	QPAB-LAN			ACCUMULATOR SENSE, PUMP UNLOAD VALVE	1
1	154-629-004		6061-T6 ALUMINUM	BODY	1
ITEM	PART NO.	SETTING	MATERIAL	PART NAME	QTY

MODEL		XQEFLANBM		ALL DIMENSIONS IN INCH VIEWS ARE THIRD ANGLE		FIRST ANGLE		THIRD ANGLE	
DESCRIPTION		Line mount		DATE	SCALE	DWG SIZE	SHEET		
				Oct-16-24	0.506	C	1		