

Technical Data	U.S. Units	Metric Units
Cavity	T-11A	
Body Features	Cross pilot with shuttle	
Body Type	Motor mount	
Interface	Eaton/Char-Lynn H & S	
Open Cavity Quantity	2	
Weight	1.686 lb.	0,765 kg.
Mounting Hole Diameter	.34 in.	8.6 mm
Mounting Hole Depth	Through	
Mounting Hole Quantity	4	

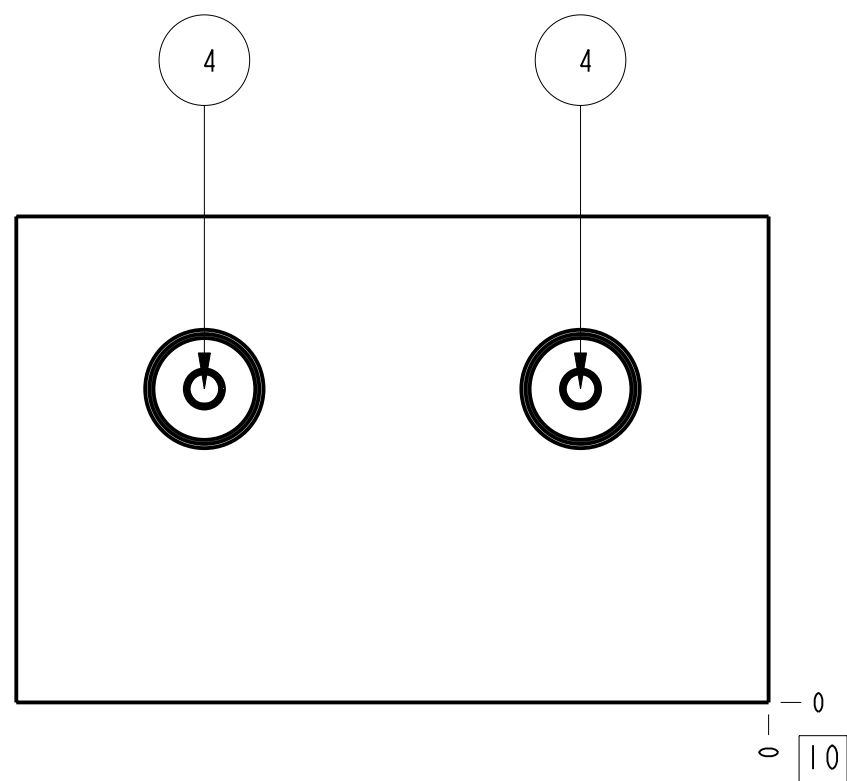
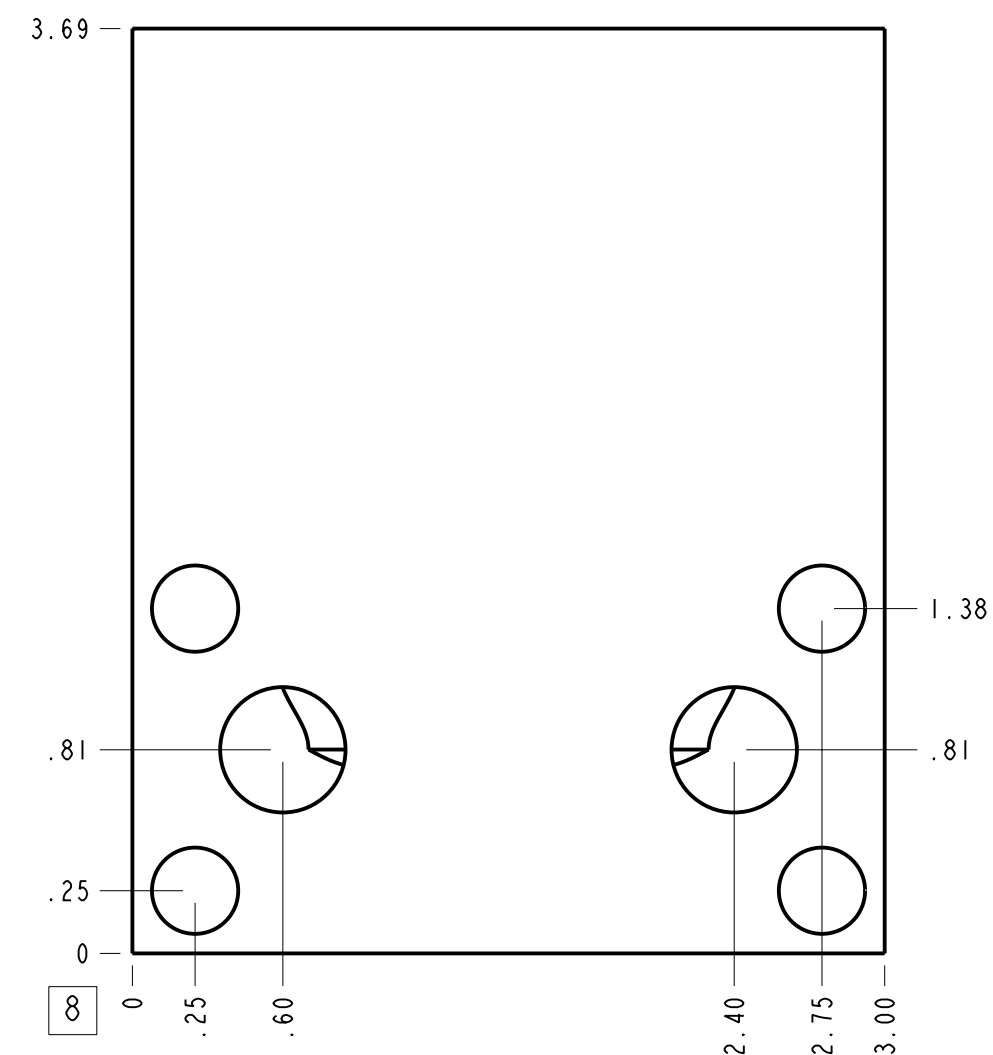
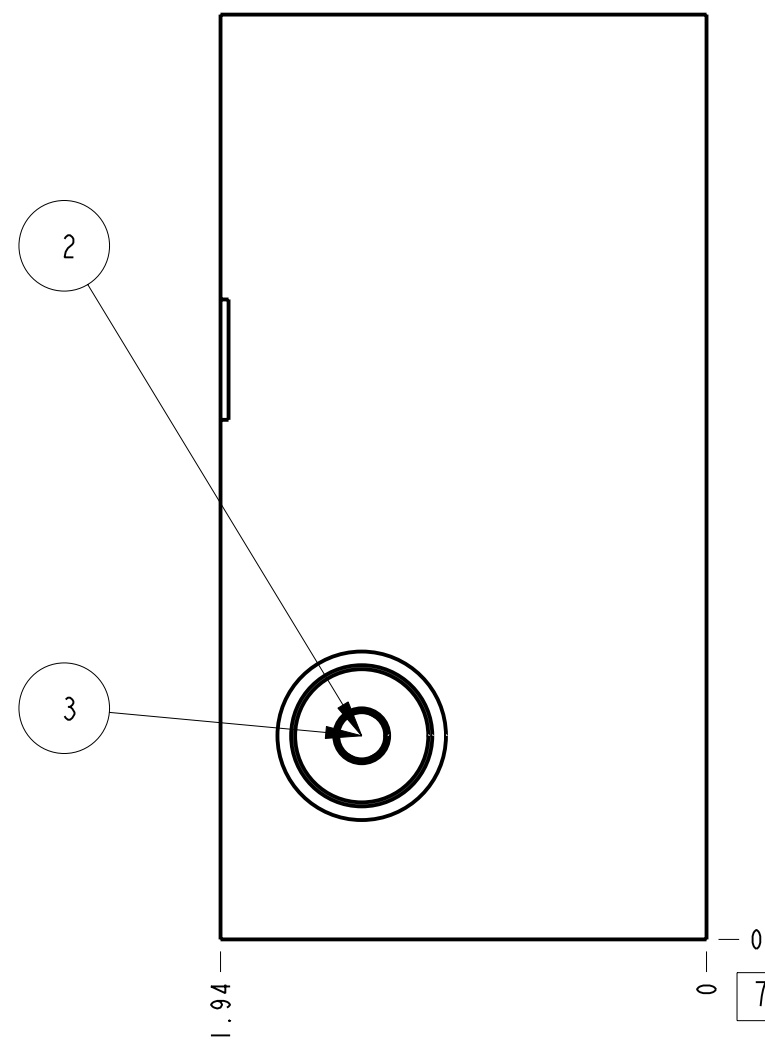
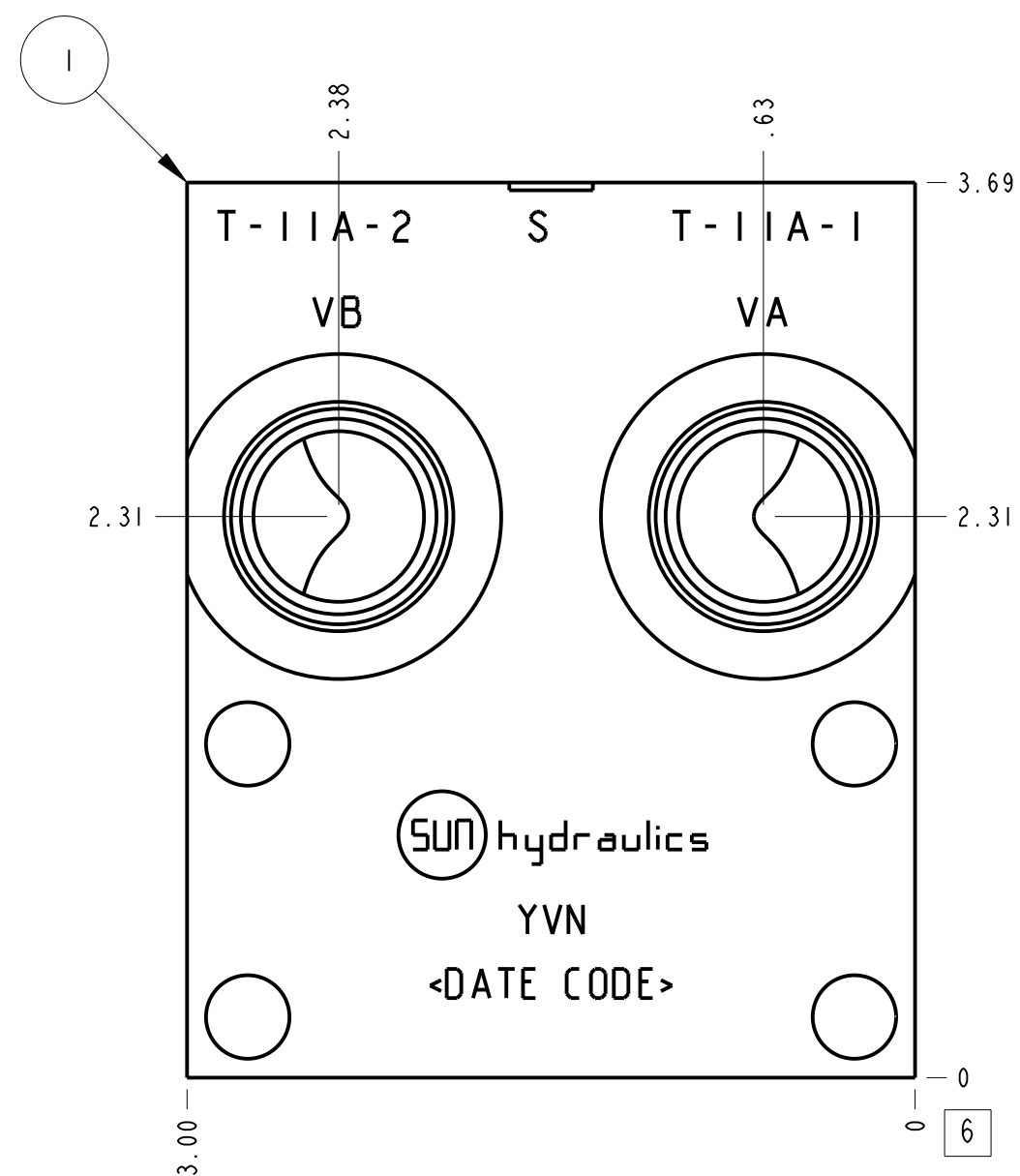
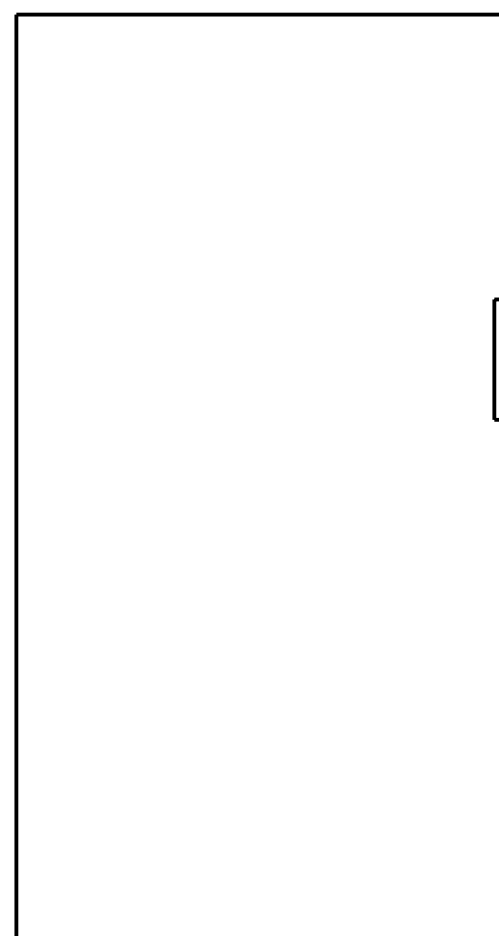

Notes

1. A riser gage port adapter is required for this product when used with the Char-Lynn "S" series motors. For details on gage port adapters, see Sun models ZVQ (NPT), WPA (SAE), and WPB (BSPP).
2. Important: Carefully consider the maximum system pressure. The pressure rating of the manifold is dependent on the manifold material, with the port type/size a secondary consideration. Manifolds constructed of aluminum are not rated for pressures higher than 3000 psi (210 bar), regardless of the port type/size specified.
3. This drawing is for reference only. It is generated by an automated process and does not fall under Sun's document control process.

Port Headings		
Product	Port	Size
YVN	Ports VA & VB	SAE 10
YVN	Port S	SAE 4

4	A330-006-002		SAE-2 PLUG	2	
3	CSZNXXN		SHUTTLE VALVE	1	
2	A330-006-004		SAE-4 PLUG	1	
1	150-790-002	6061-T6 ALUMINUM	BODY	1	
ITEM	PART NO.	SETTING	MATERIAL	PART NAME	QTY

MODEL: YVN

ALL DIMENSIONS IN INCH  
VIEWS ARE THIRD ANGLE

DESCRIPTION: T-11A Motor mount Eaton/Char-Lynn H & S  
Cross pilot with shuttle

DATE: Aug-28-23

SCALE: 1.306

DWG SIZE: C

SHEET: 1

FIRST ANGLE

THIRD ANGLE