

Technical Data	U.S. Units	Metric Units
Cavity	T-2A	
Body Features	Cross pilot with shuttle	
Body Type	Line mount	
Interface	None	
Open Cavity Quantity	2	
Weight	1.636 lb.	0,742 kg.
Mounting Hole Diameter	.41 in.	10,4 mm
Mounting Hole Depth	Through	
Mounting Hole Quantity	2	
Includes integral cartridge(s)	Yes (see Included Components)	

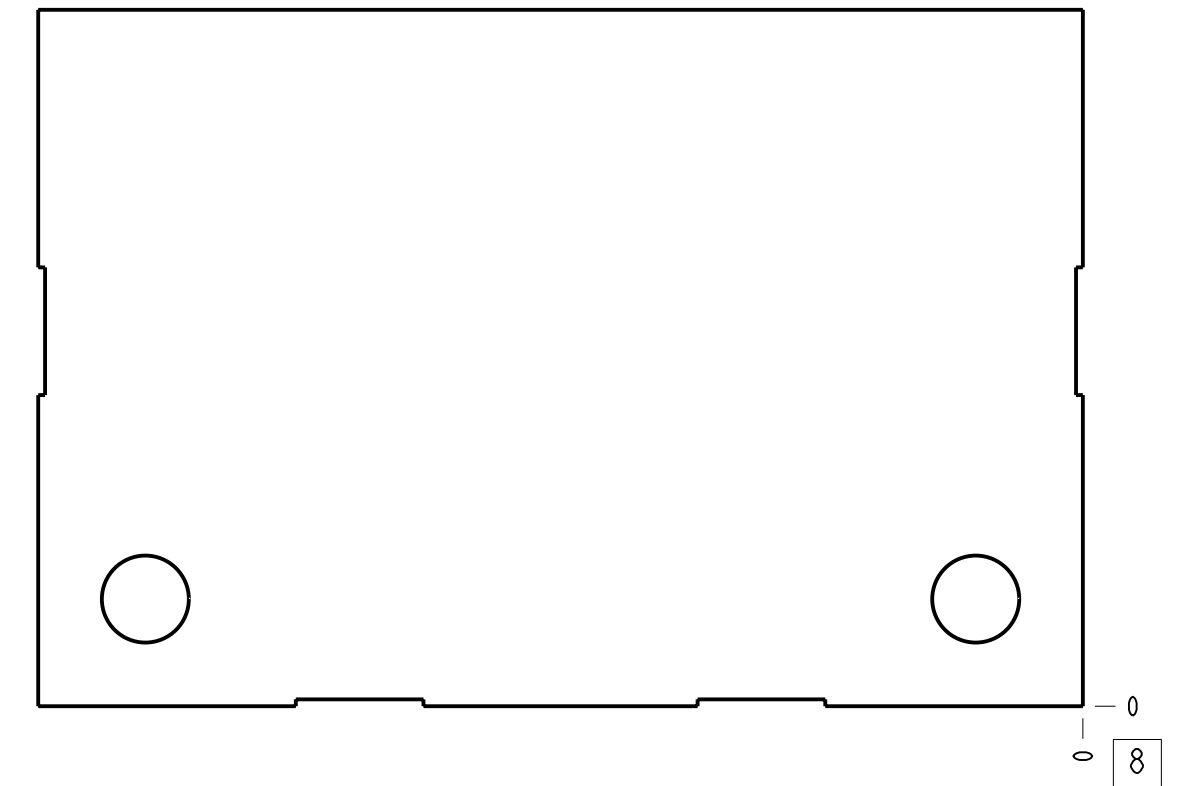

**Notes**

1. Important: Carefully consider the maximum system pressure. The pressure rating of the manifold is dependent on the manifold material, with the port type/size a secondary consideration. Manifolds constructed of aluminum are not rated for pressures higher than 3000 psi (210 bar), regardless of the port type/size specified.
2. Shuttle is accessible through the V2 port.
3. This drawing is for reference only. It is generated by an automated process and does not fall under Sun's document control process.

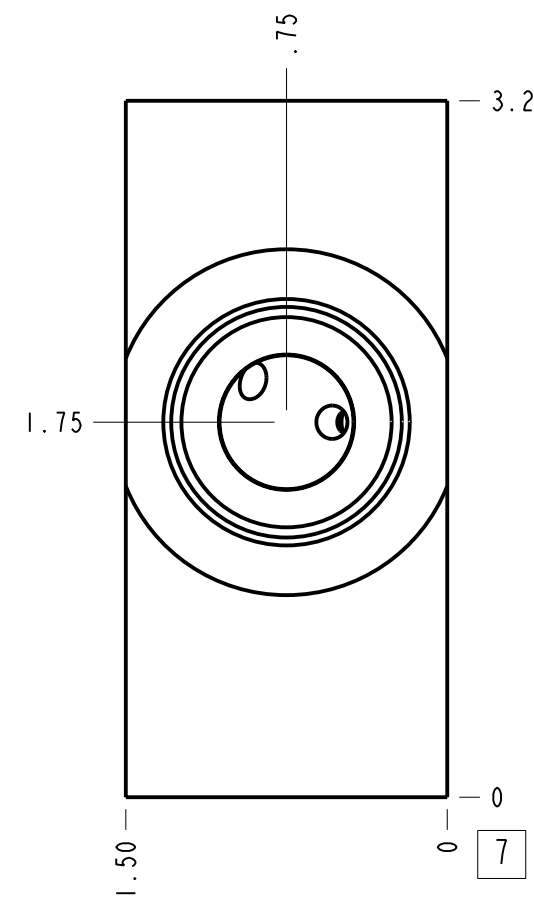
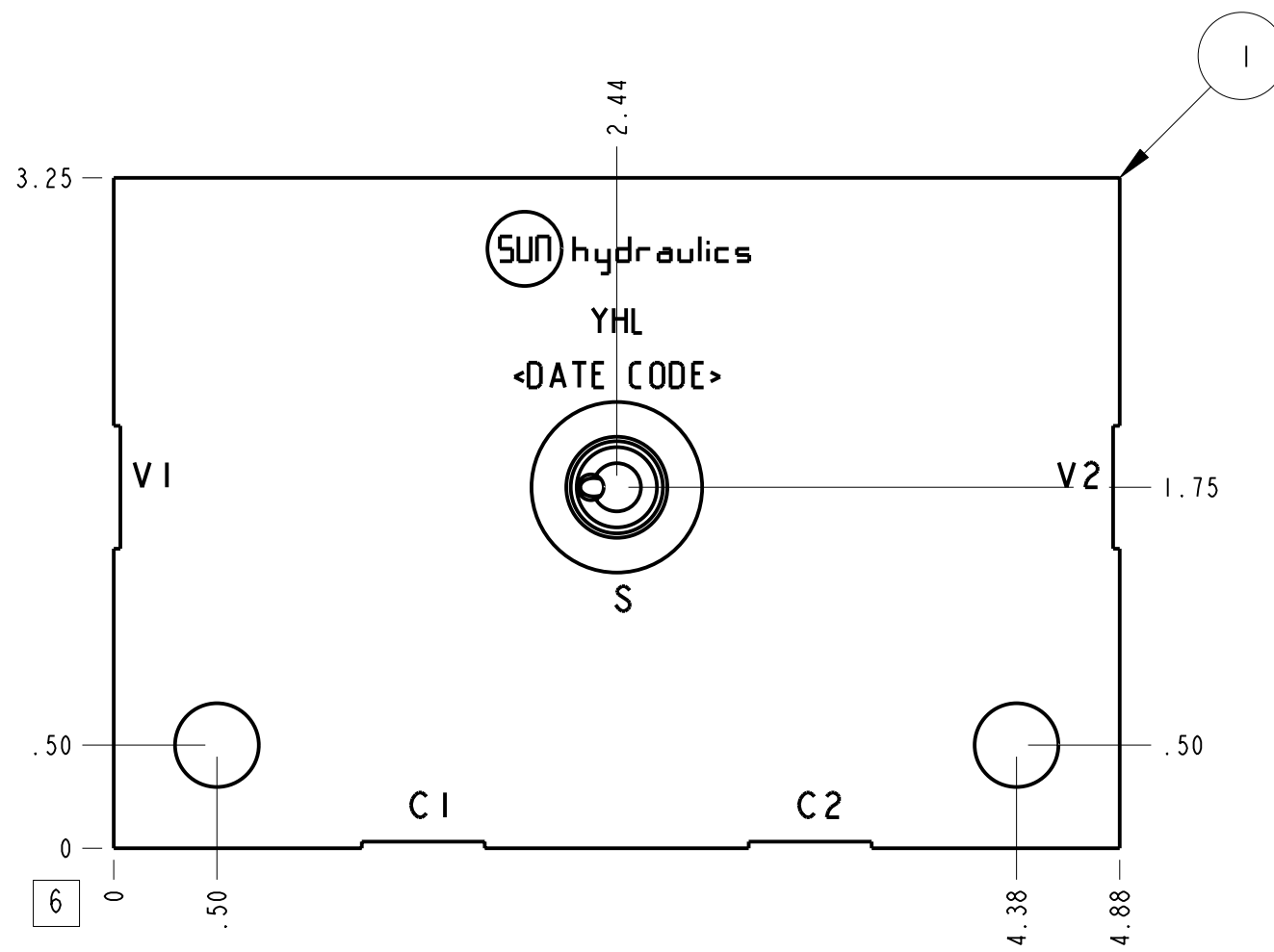
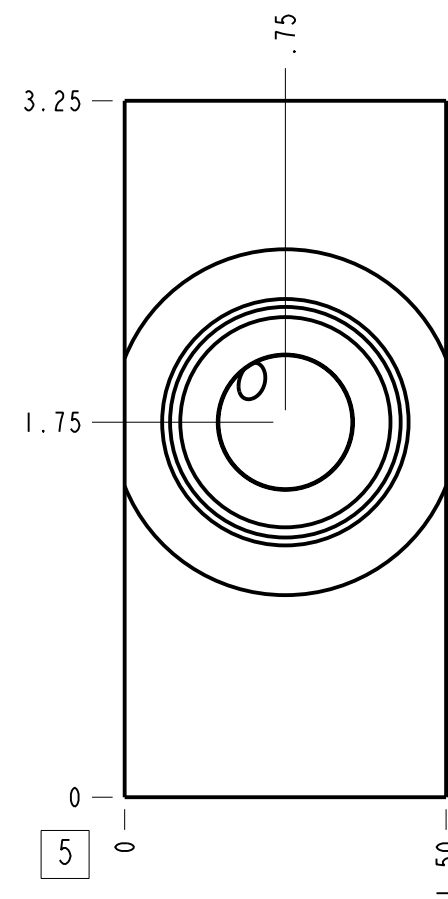
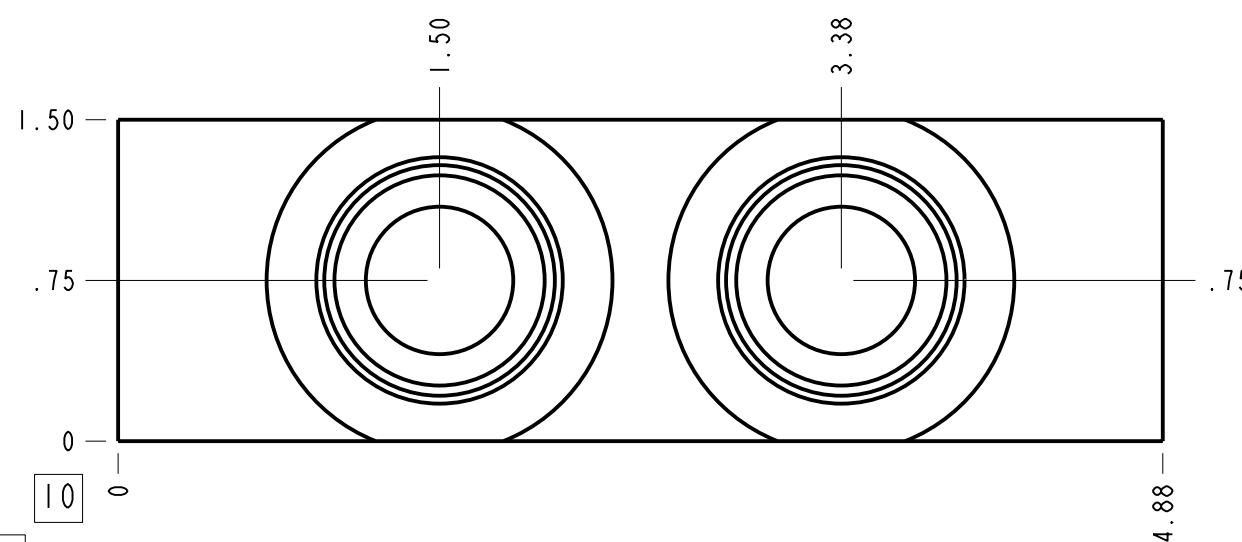

Port Headings		
Product	Port	Size
YHL	Ports C1,C2,V1,V2	SAE 12
YHL	Port S	SAE 4

I	150-033-004	6061-T6 ALUMINUM	BODY	I		
I T E M	PART NO.	SETTING	MATERIAL	PART NAME	Q T Y	
MODEL	YHL		ALL DIMENSIONS IN INCH VIEWS ARE THIRD ANGLE			
DESCRIPTION	T-2A Line mount Cross pilot with shuttle		DATE	SCALE	DWG SIZE	SHEET
			May-29-24	1.116	C	I

