

Technical Data	U.S. Units	Metric Units
Cavity	T-3A	
Body Features	Cross port with gauge ports	
Body Type	Line mount	
Interface	None	
Open Cavity Quantity	2	
Weight	5.919 lb.	2,685 kg.
Mounting Hole Thread	.375-16 UNC - 2B in.	
Mounting Hole Depth	.62 in.	15,7 mm
Mounting Hole Quantity	2	

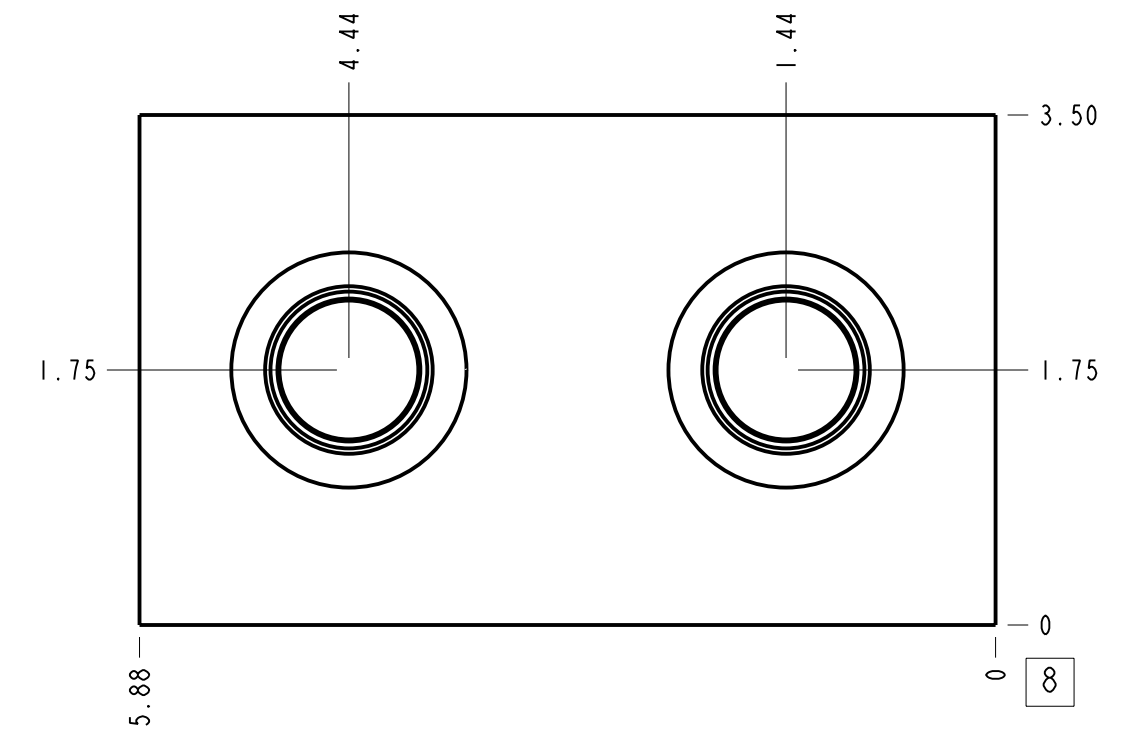

**Notes**

- Important: Carefully consider the maximum system pressure. The pressure rating of the manifold is dependent on the manifold material, with the port type/size a secondary consideration. Manifolds constructed of aluminum are not rated for pressures higher than 3000 psi (210 bar), regardless of the port type/size specified.
- This drawing is for reference only. It is generated by an automated process and does not fall under Sun's document control process.

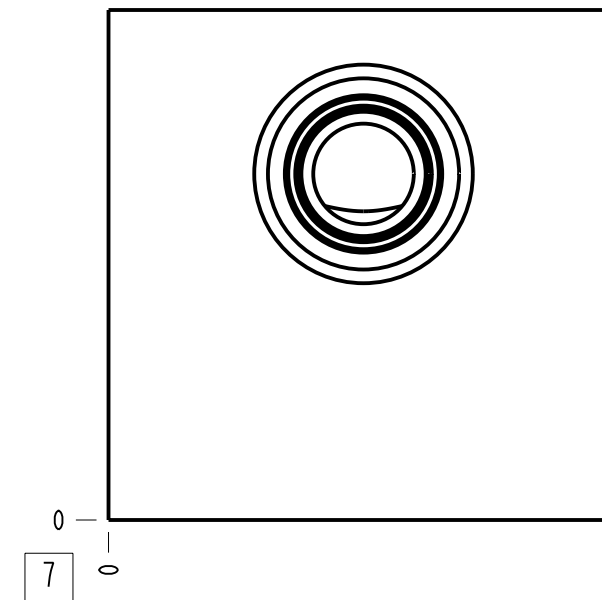
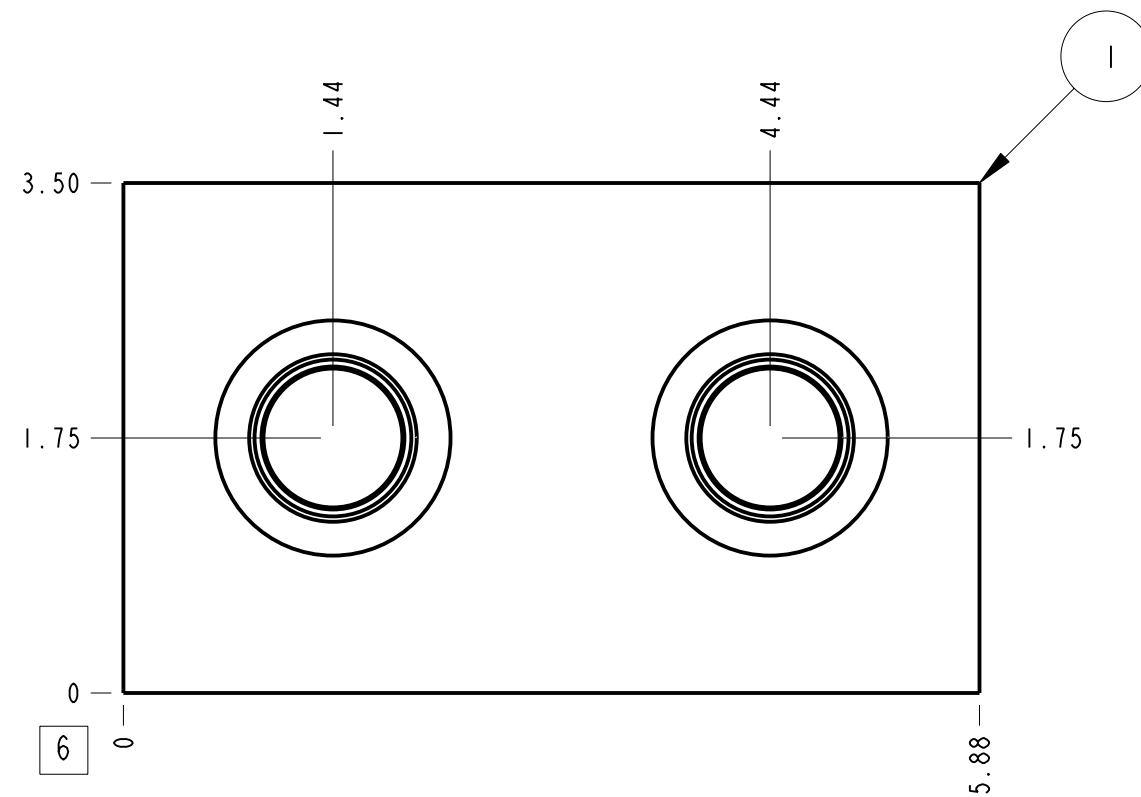
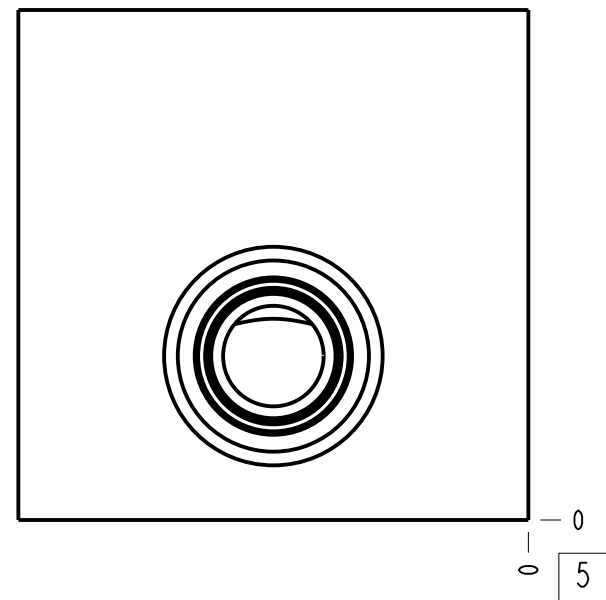
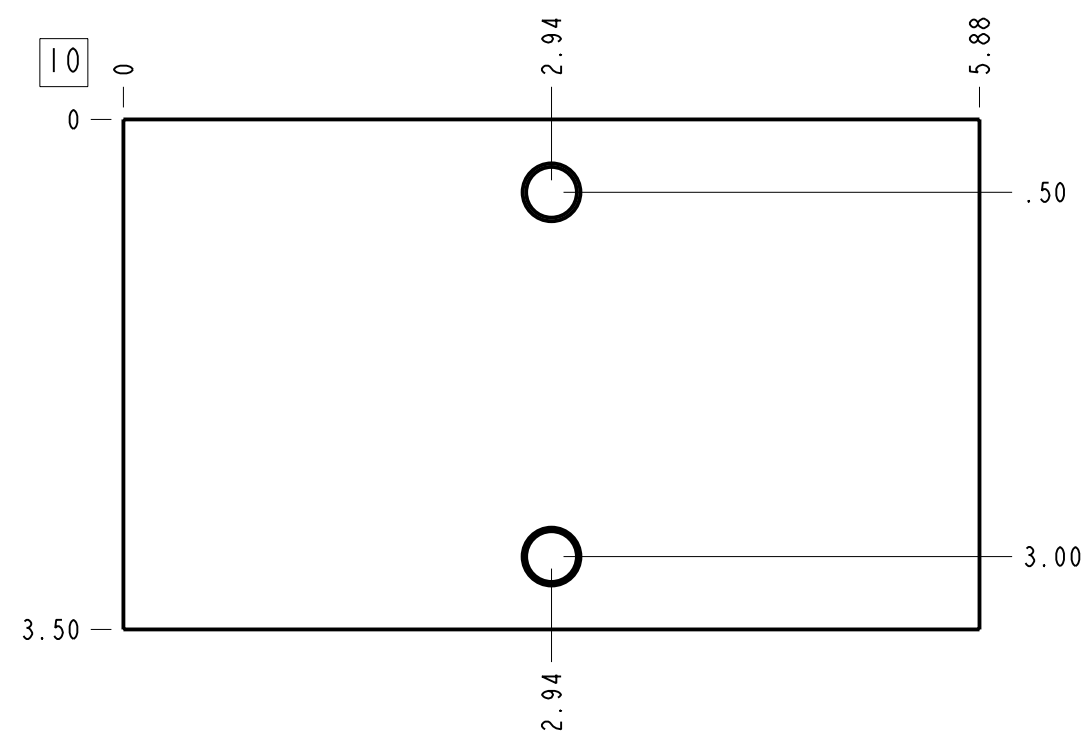

Port Headings		
Product	Port	Size
YCL	Ports 1 & 2	SAE 12
YCL	Gage Ports	1/4" NPTF

ITEM	150-696-003	6061-T6 ALUMINUM	BODY	QTY
MODEL	YCL	ALL DIMENSIONS IN INCH VIEWS ARE THIRD ANGLE		1
DESCRIPTION	T-3A Line mount Cross port with gauge ports	DATE	SCALE	DWG SIZE
		Sep-19-23	0.759	C 1

