

Technical Data	U.S. Units	Metric Units
Cavity		T-17A
Body Features		Cushion lock
Body Type		Line mount
Interface		None
Open Cavity Quantity		2
Weight	11.507 lb.	5,219 kg.
Mounting Hole Diameter	.53 in.	13,5 mm
Mounting Hole Depth		Through
Mounting Hole Quantity		2
Includes integral cartridge(s)		Yes (see Included Components)

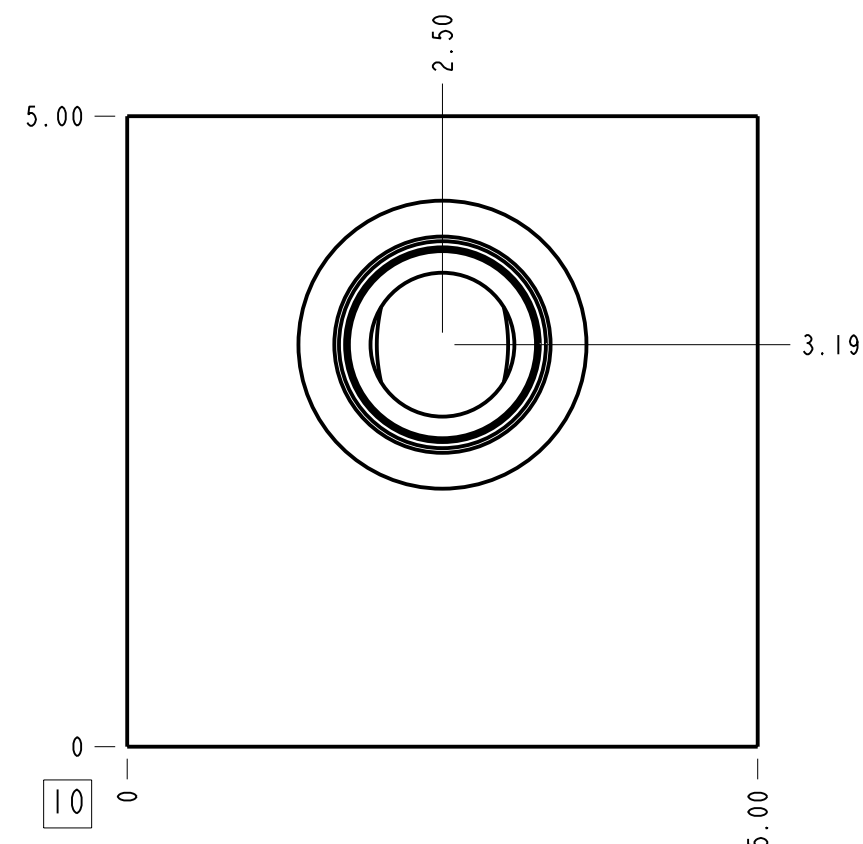
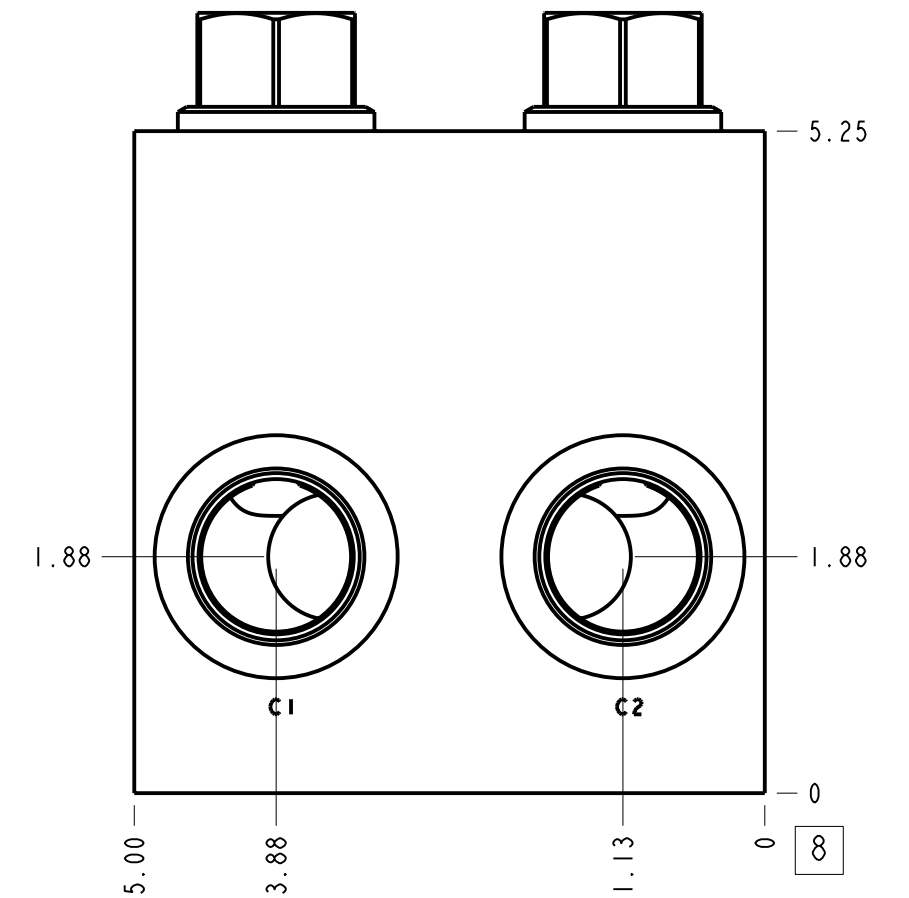
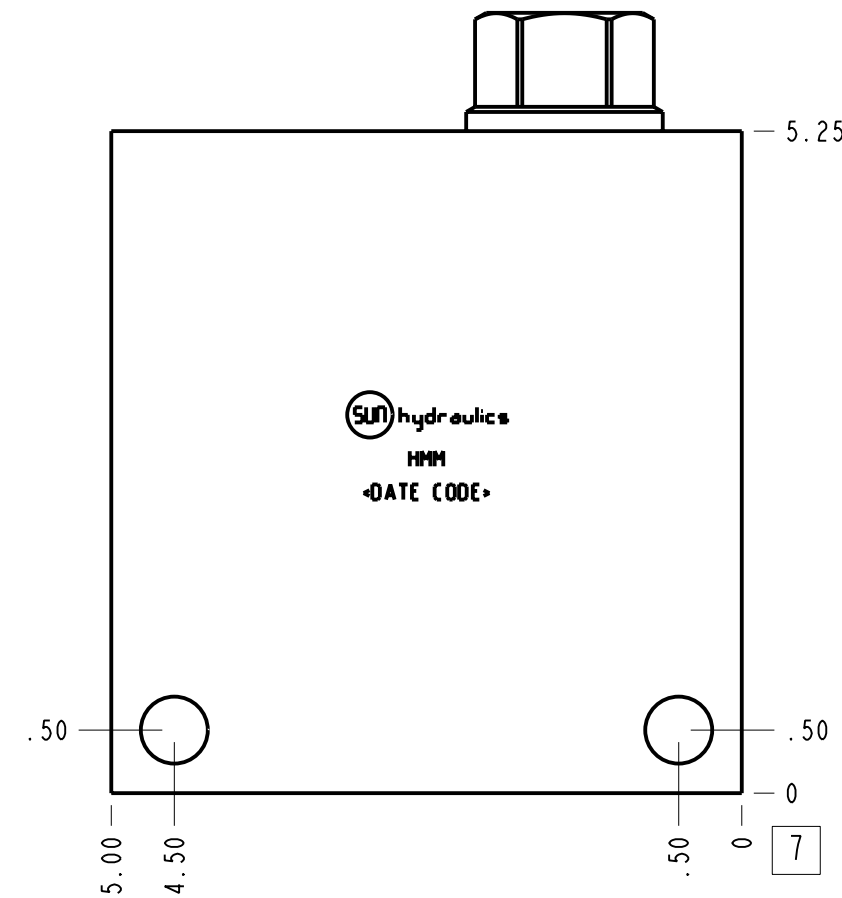
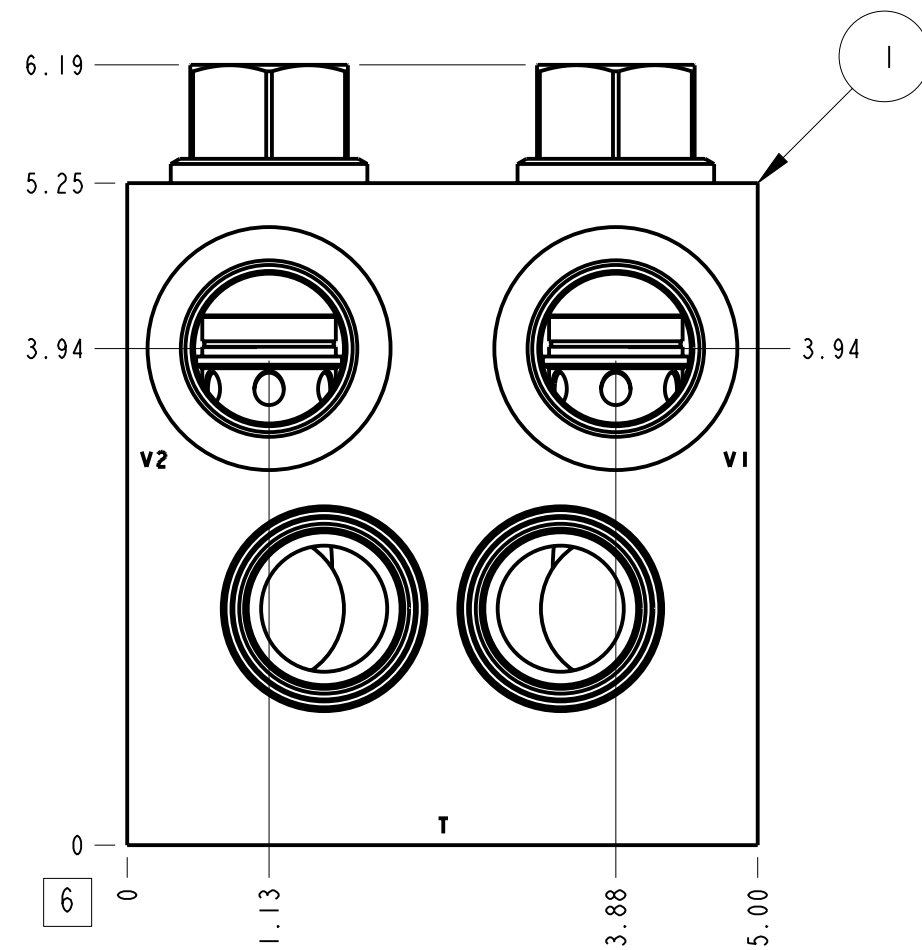
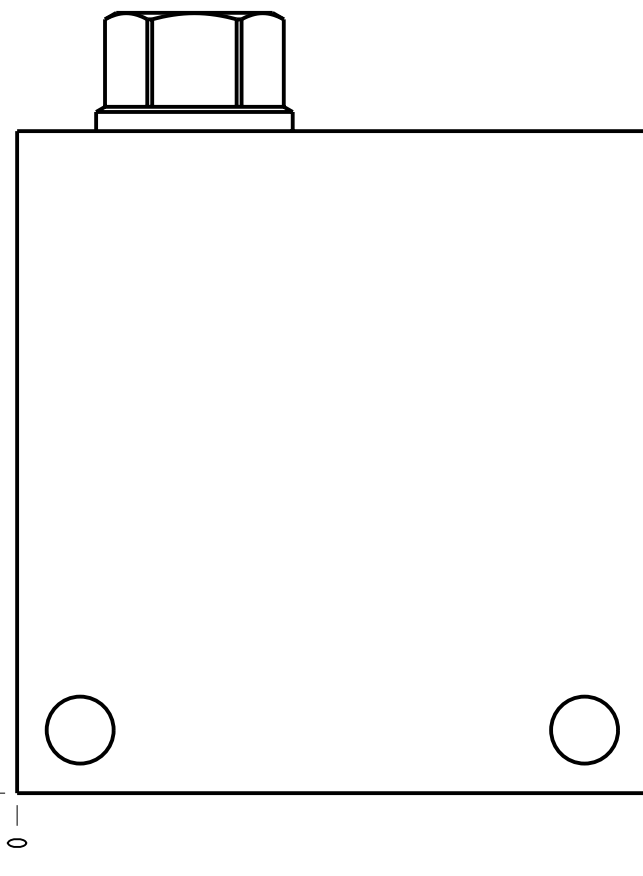

Notes

- Important: Carefully consider the maximum system pressure. The pressure rating of the manifold is dependent on the manifold material, with the port type/size a secondary consideration. Manifolds constructed of aluminum are not rated for pressures higher than 3000 psi (210 bar), regardless of the port type/size specified.
- This drawing is for reference only. It is generated by an automated process and does not fall under Sun's document control process.

Port Headings		
Product	Port	Size
HMM	Ports C1,C2,V1,V2	SAE 16
HMM	Port T	SAE 20

2	CXGDXCN		CHECK VALVE	2		
1	151-179-003		6061-T6 ALUMINUM	BODY	1	
ITEM	PART NO.	SETTING	MATERIAL	PART NAME	QTY	
	MODEL		HMM	ALL DIMENSIONS IN INCH VIEWS ARE THIRD ANGLE		
DESCRIPTION		T-17A Line mount Cushion lock	DATE	SCALE	DWG SIZE	SHEET
		Jul-12-24	0.657	C	1	

