

Technical Data	U.S. Units	Metric Units
Cavity	T-11A	
Body Features	2 cylinder sequence, with reverse checks	
Body Type	Line mount	
Interface	None	
Open Cavity Quantity	2	
Weight	2.351 lb.	1,067 kg.
Mounting Hole Diameter	.34 in.	8.6 mm
Mounting Hole Depth	Through	
Mounting Hole Quantity	2	

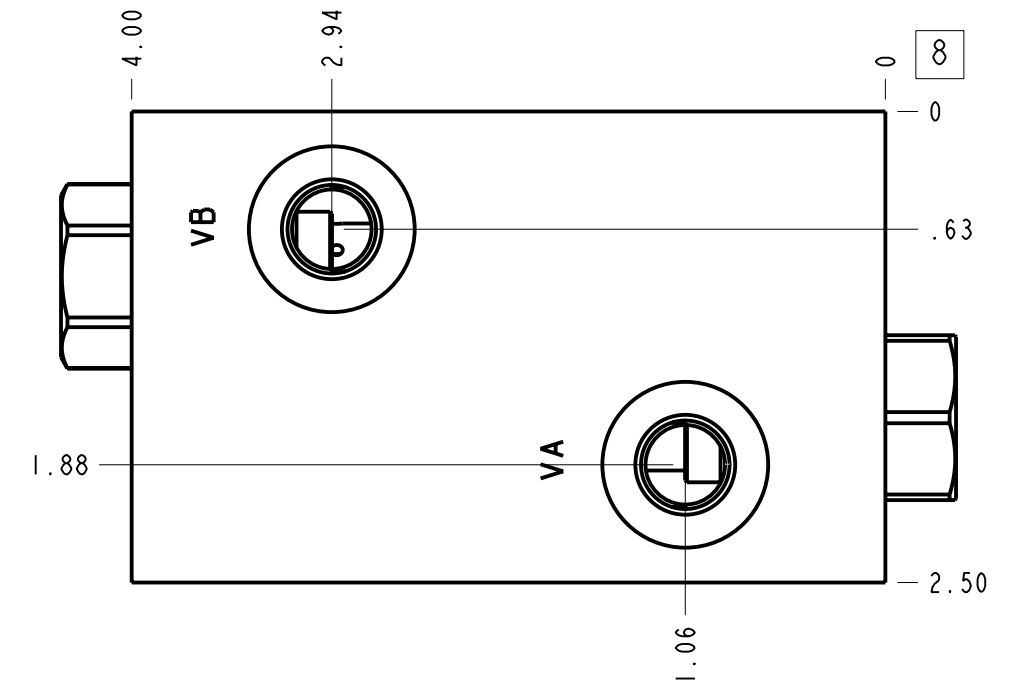

**Notes**

1. Important: Carefully consider the maximum system pressure. The pressure rating of the manifold is dependent on the manifold material, with the port type/size a secondary consideration. Manifolds constructed of aluminum are not rated for pressures higher than 3000 psi (210 bar), regardless of the port type/size specified.
2. This drawing is for reference only. It is generated by an automated process and does not fall under Sun's document control process.

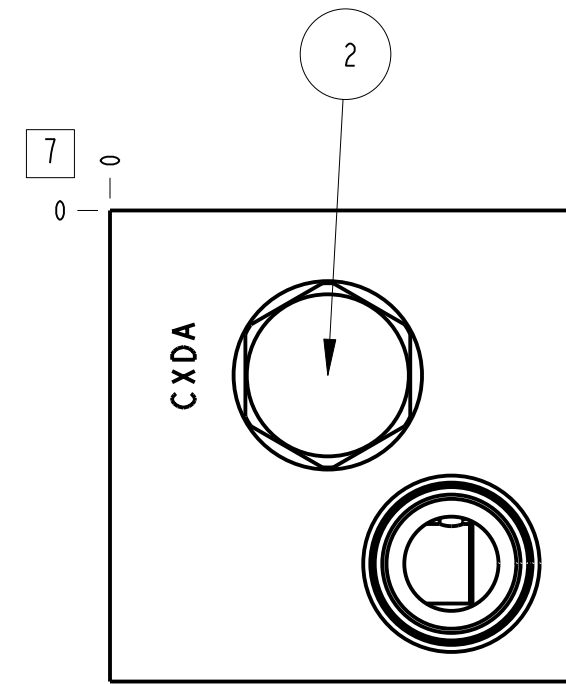
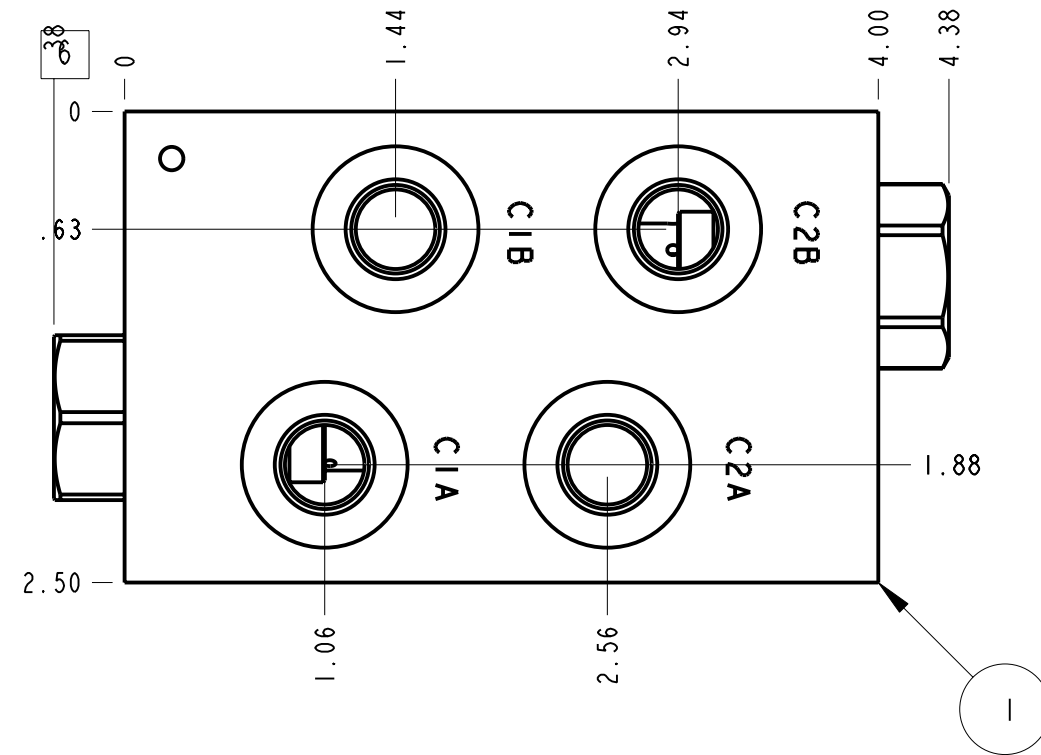
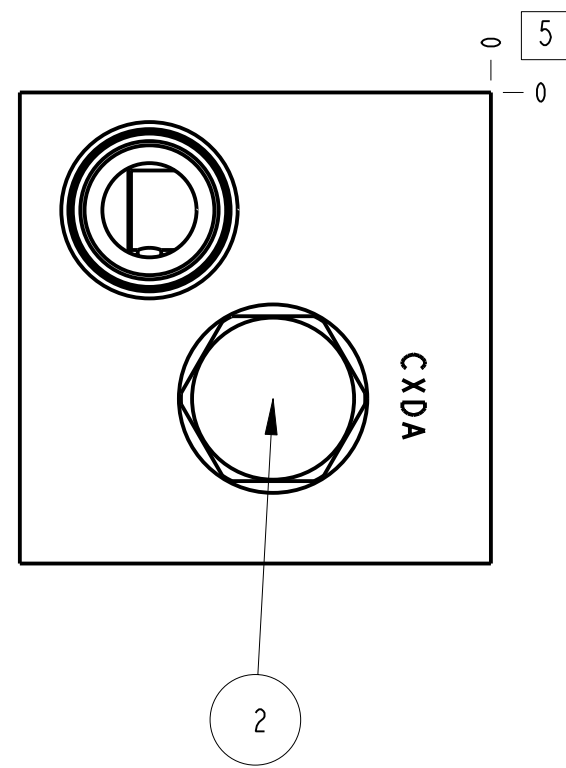
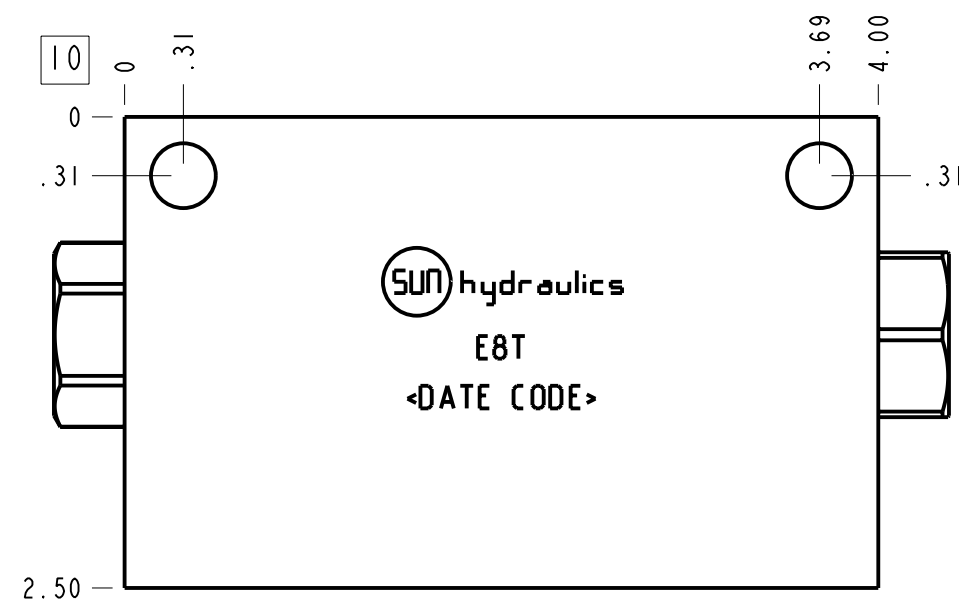

Port Headings		
Product	Port	Size
E8T	All Ports	1/4" BSPP

2	CXDA-XCN		CHECK VALVE	2	
1	150-839-007	6061-T6 ALUMINUM	BODY	1	
ITEM	PART NO.	SETTING	MATERIAL	PART NAME	QTY

MODEL: E8T

ALL DIMENSIONS IN INCH VIEWS ARE THIRD ANGLE

DESCRIPTION: T-11A Line mount 2 cylinder sequence, with reverse checks

DATE: Jan-10-24

SCALE: 0.981

DWG SIZE: C

SHEET: 1

FIRST ANGLE

THIRD ANGLE