

Technical Data	U.S. Units	Metric Units
Cavity	T-11A	
Body Features	2 cylinder sequence, with reverse checks	
Body Type	Line mount	
Interface	None	
Open Cavity Quantity	2	
Weight	2.293 lb.	1,040 kg.
Mounting Hole Diameter	.34 in.	8.6 mm
Mounting Hole Depth	Through	
Mounting Hole Quantity	2	

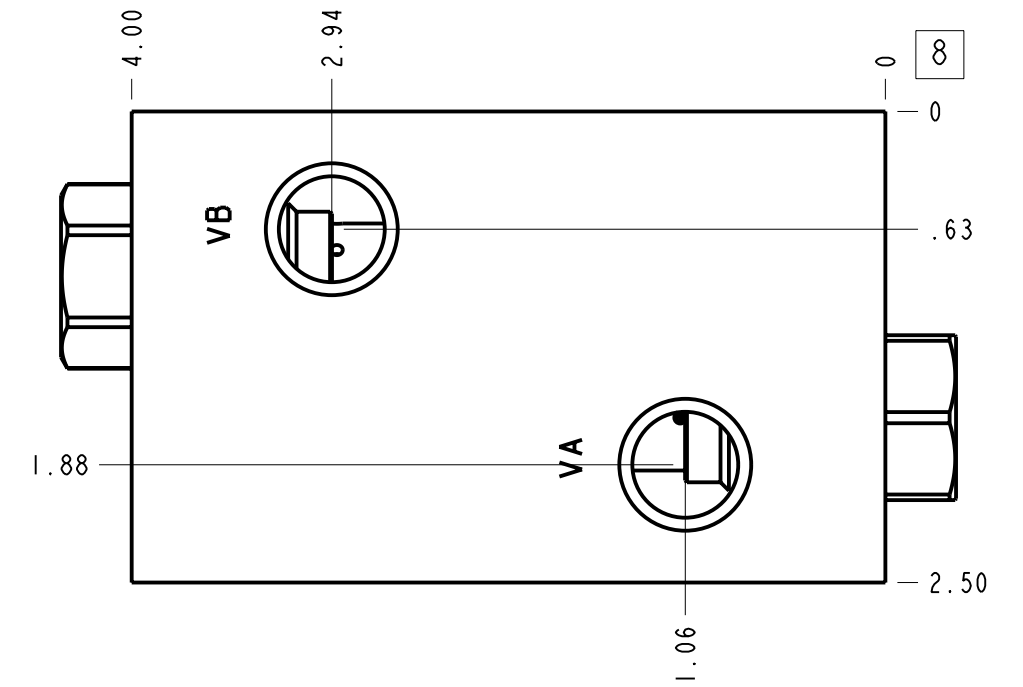

**Notes**

- Important: Carefully consider the maximum system pressure. The pressure rating of the manifold is dependent on the manifold material, with the port type/size a secondary consideration. Manifolds constructed of aluminum are not rated for pressures higher than 3000 psi (210 bar), regardless of the port type/size specified.
- This drawing is for reference only. It is generated by an automated process and does not fall under Sun's document control process.

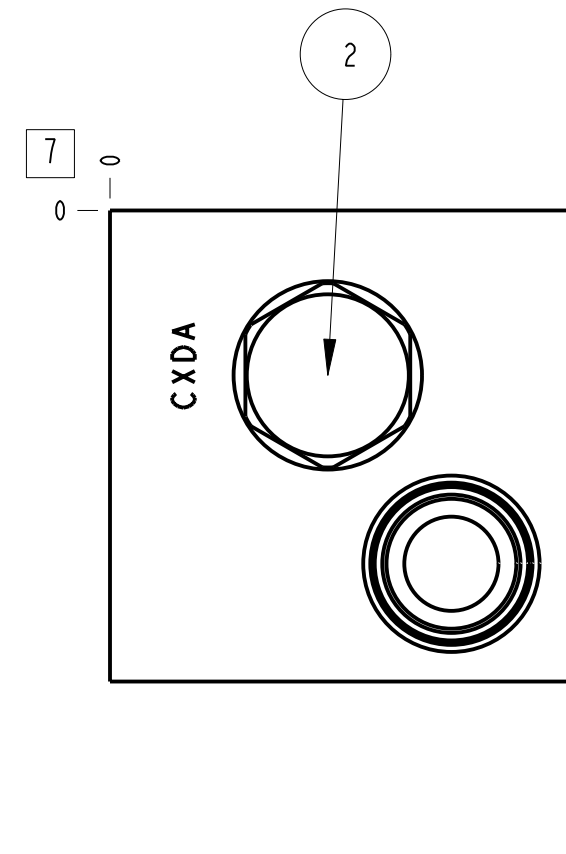
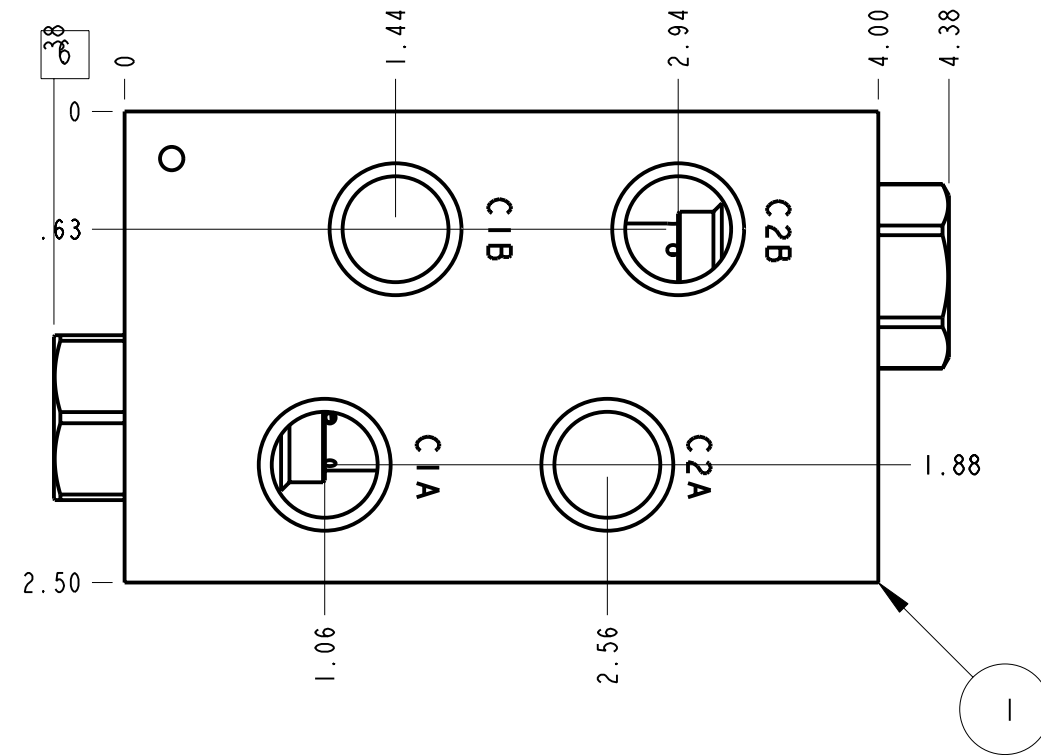
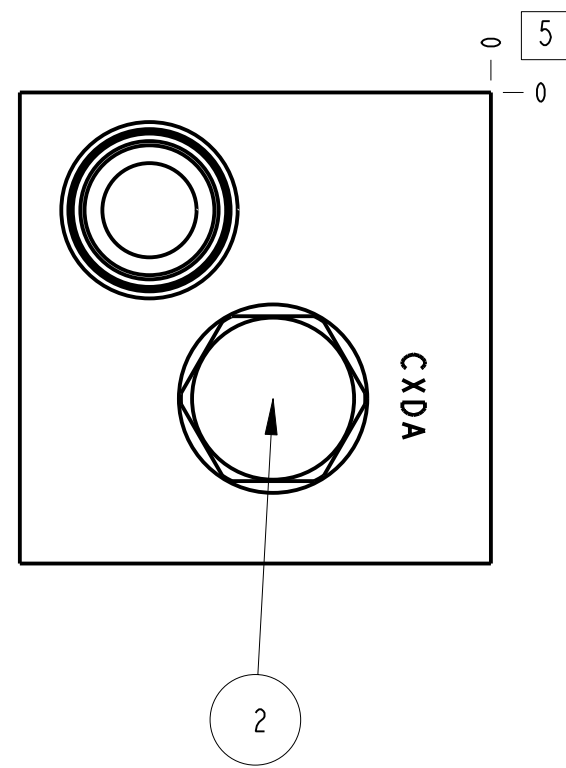
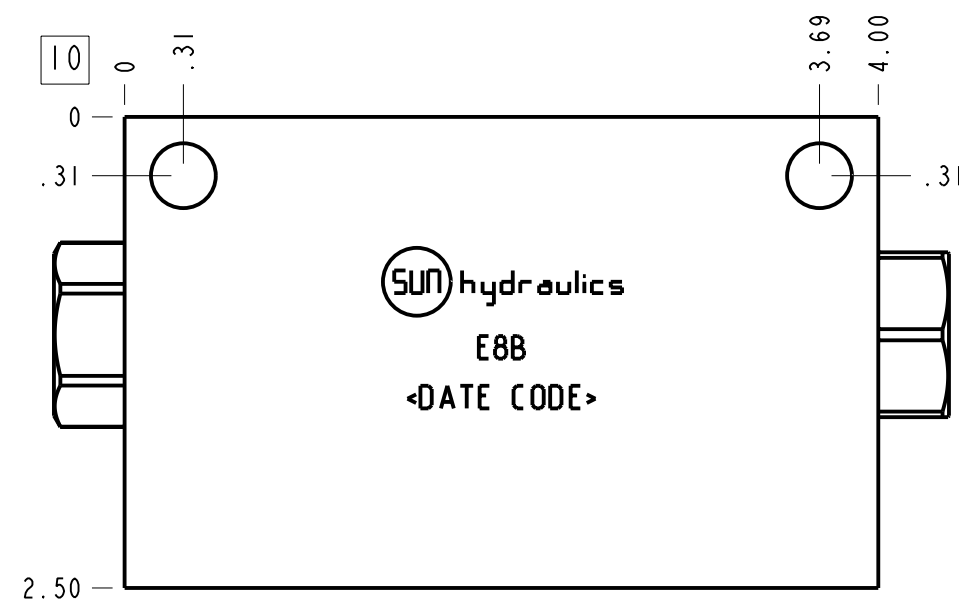

Port Headings		
Product	Port	Size
E8B	All Ports	3/8" NPTF

2	CXDA-XCN		CHECK VALVE	2	
1	150-839-002	6061-T6 ALUMINUM	BODY	1	
ITEM	PART NO.	SETTING	MATERIAL	PART NAME	QTY

MODEL	E8B		ALL DIMENSIONS IN INCH VIEWS ARE THIRD ANGLE		FIRST ANGLE	THIRD ANGLE
DESCRIPTION	T-11A Line mount 2 cylinder sequence, with reverse checks		DATE	SCALE	DWG SIZE	SHEET
			Oct-09-23	0.981	C	1

