

Technical Data	U.S. Units	Metric Units
Cavity	T-11A	
Body Features	(See Notes)	
Body Type	Line mount	
Interface	None	
Open Cavity Quantity	1	
Weight	1.914 lb.	0,868 kg.
Mounting Hole Thread	M10x1.5 - 6H	
Mounting Hole Depth	.62 in.	15,7 mm
Mounting Hole Quantity	2	
Includes integral cartridge(s)	Yes (see Included Components)	

Notes

- Important: Carefully consider the maximum system pressure. The pressure rating of the manifold is dependent on the manifold material, with the port type/size a secondary consideration. Manifolds constructed of aluminum are not rated for pressures higher than 3000 psi (210 bar), regardless of the port type/size specified.
- This drawing is for reference only. It is generated by an automated process and does not fall under Sun's document control process.
- Body Features: Through port 2 with reverse flow check and high capacity port 3.

Port Headings		
Product	Port	Size
E5U	Ports 1 & 2	3/8" BSPP
E5U	Port 3	3/8" BSPP
E5U	Gage Port	1/4" BSPP

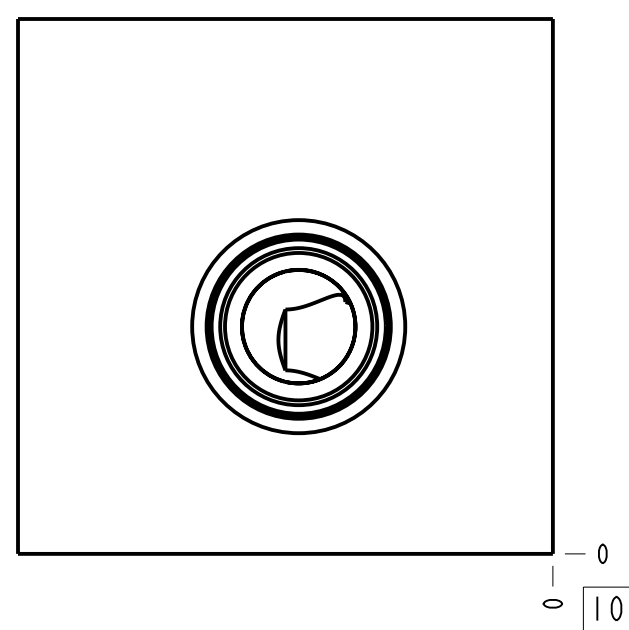

2	CXCD-XCN		CHECK VALVE	1		
1	151-199-005	6061-T6 ALUMINUM	BODY	1		
ITEM	PART NO.	SETTING	MATERIAL	PART NAME	QTY	
	MODEL		E5U	ALL DIMENSIONS IN INCH VIEWS ARE THIRD ANGLE	FIRST ANGLE	THIRD ANGLE
DESCRIPTION		T-11A Line mount (See Notes for Body Features)	DATE	SCALE	DWG SIZE	SHEET
		Feb-19-24	1.114	C	1	

